

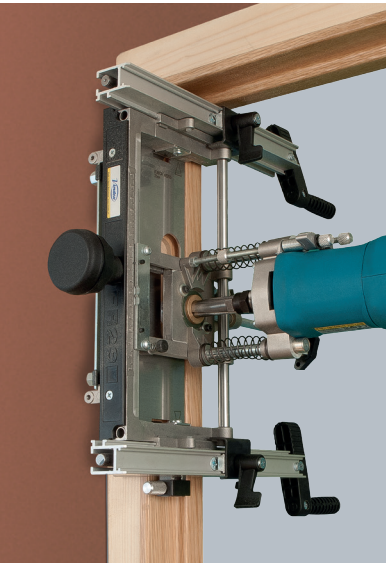

Woodworking machinery and tools



2016 / 2017



www.ney.co.uk

Installation and Restoration
of Doors and Windows

Professional solutions



CR94D | Slotting machine

Trimmer specially designed for slotting doors and windows. Allows insulating joints to be placed without removing the fittings. Ideal for fitting VIRUTEX PVC and rubber joints.



Slotting a window, flashing side.



Slotting a window, hinges side.



Slotting a window, lock side.

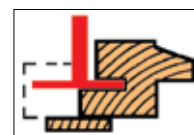

Standard equipment

Carbide bit $\varnothing 38 \times 3,5$ mm (1840040), lateral guide and service keys

Rubber & PVC insulating joints

see page 56

Slotting bits

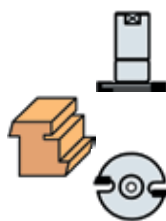

Ref.	Description	d	T
1850046	Bit holder w/bit $\varnothing 38 \times 3,5$	Shaft	HM
1840040	Slotting bit $\varnothing 38 \times 3,5$	Shaft	HM
1840051	Slotting bit $\varnothing 55 \times 3,5$	Shaft	HM
1840083	Slotting bit $\varnothing 38 \times 4$	Shaft	HM
1840084	Slotting bit $\varnothing 55 \times 4$	Shaft	HM
1850045	Cutter holder without cutter		

Specifications

Input power	550 W
No-load speed	30,000/min
Weight	2.5 kg





RA17VB | Slotting machine

Machine specially designed for slotting wooden doors and windows, for installation of silicon insulating joints. Equipped with double point 3 mm bit, two interchangeable bases, lateral fence, dust collector pipe and carrying case.



Equipped with 2 types of interchangeable fences which allow you to make slots at 45° angle or straight.



With centering pivot easing entry of the bit at the start of slotting process.

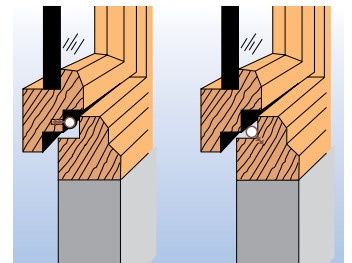

Slots on windows, doors or frames.

Optional accessoires

- 1222024 Chuck collet 8 mm
- 1222085 Chuck collet 6.35 mm (1/4")
- 1740103 Double slotting carbide bit for slot e=3
- 1740104 Double slotting carbide bit for anchor slot

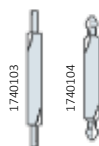

Silicon insulating joints:
see page 56



Standard equipment

Carrying case, combined double side bit, 90° guide, straight guide, reversible fence, depth gauge, service keys and dust collector connection 2.25 m.

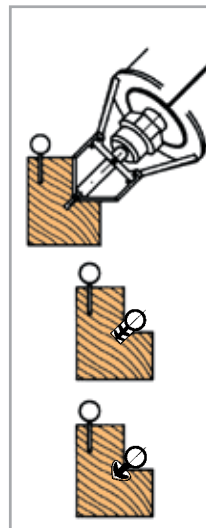

Using a 90° fence, slots at 45° angle on rabbated frames and windows.

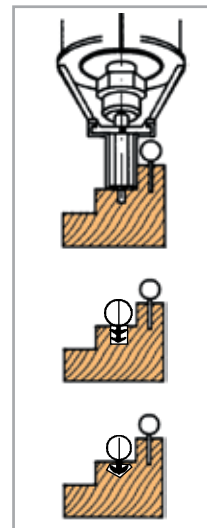

Using the straight fence: straight slots on rabbated frames and windows.

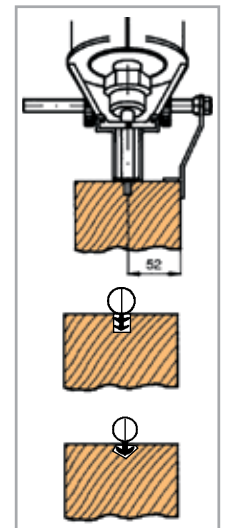

Using the straight fence and reversible square, slots on smooth areas such as the side of door hinges.



Specifications

Input power	630 W
Chuck collet	6 mm
No-load speed	28,000/min
Weight	1.9 kg

Consumables

Insulating joints

Essential for good insulation against the cold or the heat. Also give sound proofing against external noise. Perfect fit and adjustment, preventing entry of dust, smoke or humidity. Long lasting effective system which does not wear and maintains its flexibility permanently. Essential for new construction and easy to adapt to existing constructions.

Thermofusing rubber

Ref.	Description (Slotting with CR94D)
1204047	N11GT type 75 m (black colour) Min. rabbet 11 mm. Groove 10x3.5 mm
1204048	N10GT type 75 m (black colour) Min. rabbet 10 mm. Groove 10x3.5 mm
1204049	N9GT type 75 m (black colour) Min. rabbet 9 mm. Groove 8x3.5 mm
1204050	FGT type 100 m (black colour) Groove 6x3.5 mm



P.V.C.

Ref.	Description (Slotting with CR94D)
1204038	N11P type 75 m (brown colour). Min. rabbet 11mm. Groove 10x3.5 mm.
1204039	N10P type 75 m (brown colour). Min. rabbet 10 mm. Groove 10x3.5 mm.
1204040	N9P type 75 m (brown colour) Min. rabbet 9 mm. Groove 8x3.5 mm.
1204140	N9P/B type 75 m (white colour) Min. rabbet 9 mm. Groove 8x3.5 mm.



P.V.C.

Ref.	Description (Slotting with CR94D)
1204041	FP type 100 m (brown colour) Groove 6x3.5 mm
1204141	FP/B type 100 m (white colour) Groove 6x3.5 mm
1204036	PL11P type 75 m (brown colour) Min. rabbet 11 mm. Groove 8x3.5 mm
1204037	PL10P type 75 m (brown colour) Min. rabbet 10 mm. Groove 8x3.5 mm
1204042	PP type 100 m (brown colour) Groove 8x3.5 mm



Silicon insulating joints

Maximum duration, excellent resistance to different climates and elasticity. They resist between -60 to 200 C.

Ref.	Description (Slotting with RA17VB)
1204081	FS1 type 100 m (brown colour) Diameter 8 mm. Groove 5x3 mm
1204181	FS1/B type 100 m (white colour) Diameter 8 mm. Groove 5x3 mm
1204086	FS3 type 100 m (brown colour) Diameter 6 mm. Groove 5x3 mm
1204186	FS3/B type 100 m (white colour) Diameter 6 mm. Groove 5x3 mm
1204082	FS2 type 100 m (brown colour) Diameter 8 mm, anchor groove
1204182	FS2/B type 100 m (white colour) Diameter 8 mm, anchor groove
1204087	FS4 type 100 m (brown colour) Diameter 6 mm, anchor groove
1204187	FS4/B type 100 m (white colour) Diameter 6 mm, anchor groove



Placing rollers

For placing insulating joints



Ref.	Description
1746158	Roller for FS1, FS1/B, FS2, FS2/B, FS3, FS3/B, FS4 and FS4/B types
1850036	Roller for FP, FP/B and FGT types
1850037	Roller for N9P, N9P/B, N9GT, N10GT, PL10P, N10P and PP types
1850047	Roller for PL11P, N11P, N11GT types



Video



Patented model

RM95S | Door frame cutting machine

The definitive solution for changing doors on restoration works, keeping the original door dimensions.

Adjustable cutting up to 155 mm width. It is also possible to cut the crossbeam. The powerful 1800 W motor, soft starting and chain saw give an easy and fast cutting.

Quick assembly and adjustment.

Pinion rack system, for a smooth movement and cut with no-return system for a safety operation.

Dust collector connection and cord 5 m long.



Equipped with an effective chain saw for a clean and easy cut. Fitted with safety protections to avoid any contact with the chain saw, even during the cut.



Solid and efficient pinion rack system for a total control of cut.



Practice system to fix the machine to the frame and to adjust the cutting width.

Clean cut allowing to fix the new frame directly on the old ones.



Standard equipment

- Cutting machine with chain saw
- Metal detector **A**
- Carrying case for the machine
- Carrying bag for the guides
- Lubricating oil (125 ml)



Specifications

Input power	1,800 W
Chain saw speed	15 m/s
Max. cutting depth	155 mm
Chain saw	3/8" 41 links
Weight	20.5 kg



Optional accessories

- 7000910 RV170U set for cutting frames up to 68 mm width
- 9500150 AC95R accessory for cutting crossbeams
- 9599263 Lubricating oil for RM95R (1 litre)
- Only for special purposes when the standard guide is too high.
- 9545751 Upper guide max. height 194 cm
- 9545752 Upper guide max. height 206 cm



Trolley for transport

RMV70U | Door frame cutting machine

The RMV70U door and window frame trimmer is used to trim door and window frames up to 68 mm thick, allowing their original size to be retained. It has a hard metal saw blade which trims very quickly while moving over a detachable guide, so guaranteeing a guided and stable cut. The machine comes as standard with the guide for trimming door frames and with the accessories required for trimming window frames, a process which does not require the guide because the RMV70U has an adjustable front square which efficiently guides the machine while trimming the frame. The RMV70U comes with an effective external dust collecting system and for which a dust collection tube compatible with the entire Virutex range of dust collectors is included as standard. The RMV70U can be quickly assembled and adjusted and since all of the equipment fits into a practical case with wheels, included as standard, it is very easy to transport.



Clean cut allowing to fix the new frame directly on the old ones.



Trimming wooden window frames. Register on the adjustable front guide square.



Diamond blade for cutting building materials for the complete extraction of the frame. Register on the straight front of the reversible base.

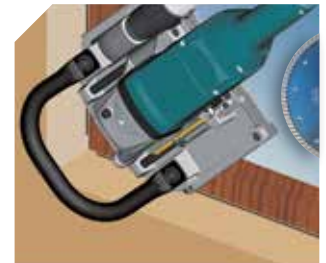

Makes cutting slots in the 4 corners easy. Register on the bevelled front of the reversible base.

Standard equipment

Guide and accessories for trimming door frames, front fence for trimming windows, 30z MD blade for trimming wood. 3m dust collection tube, metal detector (A) and a practical carrying case with wheels.



Specifications

Input power	1,700 W
No-load speed	6,500/min
Max. cutting depth with saw blade	68 mm
Driving unit weight	6.6 Kg
Total equipment weight	29 kg

Optional accessories

7040329 D.180 diamond blade to "dig out" window frames. Maximum cutting depth: 58 mm
 9500250 MRM95S chainsaw. Allows you to make cuts of up to 155 mm thick in door frames and includes all of the accessories required to adapt it to the guide included as standard with the RMV70U.



RV70U | Window frame cutting machine

The new RV70U trimmer is designed to cut wooden window frames and for use in restoration work or window replacement by creating slots around the frame, making it easier to extract the frame support.

For window frame cutting, the RV70U is equipped with a special saw blade of 12 hard metal teeth and an adjustable front square guide which is used as a support guide for the cut. To create slots in the frame support structure, the RV70U also comes with a diamond blade designed to cut building materials. It can even make slots in the four corners; to do this the user simply has to change the position of the machine's reversible base to the bevelled side.

The new RV70U makes the task of replacing windows much easier while retaining the original size or even increasing it in some cases. It is also an indispensable tool for installing aluminium or wooden windows.



Trimming wooden window frames. Register on the adjustable front guide square.



Diamond blade for cutting building materials for the complete extraction of the frame. Register on the straight front of the reversible base.

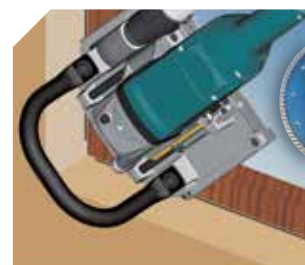

Makes cutting slots in the 4 corners easy. Register on the bevelled front of the reversible base.

Carbide saw blade for wood 12Z Ø 200 (ref. 7040371) and diamond blade Ø 180 (ref. 7040329) for building materials as standard equipment.



Standard equipment

Front square guide to trim windows, 12Z MD D.200 blade to cut wood, D.180 diamond blade to cut building materials, 3-m dust collection tube and carrying case.



Optional accessories

9545854 Kit GRM70S: includes the guide and the accessories needed to turn the RV70U into a door frame trimmer.
7040330 Saw blade D.200 30 Z

Specifications

Input power	1,700 W
No-load speed	6,500/min
Max. cutting depth with saw blade	68 mm
Max. cutting depth diamond blade	58 mm
Height of the cut from the base	7 mm
Weight	6.6 kg



Video



FR129VB | Router for fitting hinges

Special router for installation of all kind of hinges on frames and any kind of doors.

Easy fitting of 3 or 4 hinges per door (right or left open), without to take measurements and marking.

The double depth stopper allows to mortise both depths of concealed hinges in one operation, without changing the template. The router is also prepared for fitting any kind of traditional hinges.

New and easy to adjust clamp system that holds the router perfectly on the door and frame, without damaging its surface. To place the template on the machine is also very fast; it is fixed and ready to use by pressing it inside the guide.

The FR129VB is equipped with a powerful motor of 1,000 W, electronic speed adjustment and electronic system to maintain constant speed under load. Carrying case included.

Models:

Router for hinges FR129VB with kit for concealed hinges. Allows to fit hinges with or without template. Available with kits of Ø 14, 15, 16 & 20 mm.

Router for hinges FR129VB for fitting hinges with or without template. Kit for concealed hinges in option.



Making the upper recess on the frame.



Making the second recess on the frame.



Perfect finishing.
Installation of concealed hinges in fast and one step operation. No need to change the template.



Standard equipment

Machine equipped with template, carbide bit Ø 7.6 mm (ref. 1140059) and guide ring ref. 2950105, 2 recess distributor rods for 3 or 4 hinges, service keys, carrying case.

To make other recesses both on frames and doors it is not necessary to readjust the machine.



Optional accessories

Kits for fitting concealed hinges

- 2946765 kit for fitting concealed hinges with carbide bit Ø14 mm
- 2946768 kit for fitting concealed hinges with carbide bit Ø15 mm
- 2946767 kit for fitting concealed hinges with carbide bit Ø16 mm
- 2946766 kit for fitting concealed hinges with carbide bit Ø20 mm



Guide rings

- 2950104 Ø ext. 10 mm (for 6 mm bits)
- 2950105 Ø ext. 12 mm (for 8 mm bits)
- 2950106 Ø ext. 14 mm (for 10 mm bits)
- 2950107 Ø ext. 16 mm (for 12 mm bits)
- 2950081 Ø ext. 18 mm (for 14 mm bits)
- 2950108 Ø ext. 20 mm (for 16 mm bits)

Bits

- 1640383 Carbide bit Ø14 mm
- 1640379 Carbide bit Ø15 mm
- 1640127 Carbide bit Ø16 mm
- 1640367 Carbide bit Ø20 mm



RC29M Corner chisel (optional)

This accessory allows to cut the radiuses left by the bit on the corners of the trimmed recesses for hinges, giving an exact 90° corner. It is very useful when fitting hinges with square corners. Solid and ergonomic design protects the user from the cutting blades.



Optional accessories

- Templates for fitting different types of hinges
- 2935142 Special eyebolt templates

Specifications



Input power	1,000 W
No-load speed	14,000 - 27,000/min
Chuck collet	8 mm
Max. bit diameter	32 mm
Max. trimming dim.	165 x 74 mm
Max. trimming depth	11 mm

Max. trimming depth (with kit for concealed hinges)	40 mm
Max. clamp opening*	200 mm
Min. clamp opening	33 mm
Weight	4.3 kg

(*) Also available with max. opening clamp up to 250 mm.



Templates for fitting hinges



3 body template holder A093.



Templates for fitting hinges

VIRUTEX pin hinge templates are designed to facilitate the quick seating of all types of hinges. Allows seating the hinges without taking measurements of either the door frame or the door. Can be adjusted to work at any recess depth. Functions equally for both left and right side opening doors and for any standard or intermediate door height. Very easy operation using a VIRUTEX trimmer with the appropriate head. By order, we manufacture templates for any type of hinge. The special templates are manufactured with the help of laser technology to ensure a high quality finish. There are three models of template-holders which can be combined with the different templates depending on the type of hinge, including security doors with 4 hinges.



Fitting on a frame.
(Mod. A093)



Fitting on a door.
(Mod. A093)

Template holders

3600000 A093 Three-body template holder for fitting hinges

3900000 AM94 Four-body template holder for fitting hinges

1900000 AV93 Single body template holder for fitting hinges

1900200 PP19H Single body template holder for fitting eyebolts



Mod. PP19H



Mod. AV93

The ideal machine for fitting hinges



FR192N trimmer

Templates for fitting different types of hinges.



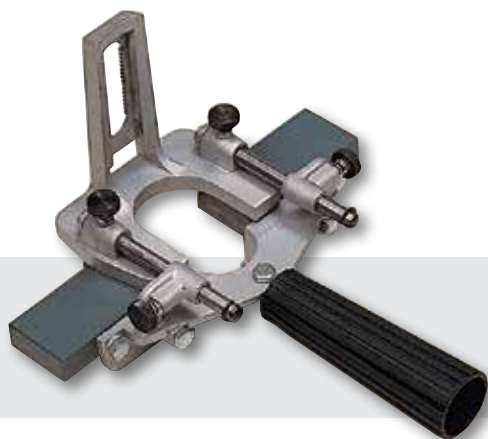

ZB93 | Trimming head for fitting hinges

The ZB93 head is specially designed to be used together the FR192N trimmer for fitting hinges without template.

The combination of both tools offers a practice and professional solution for placing hinges without template.



Placing hinges with the ZB93 head.



EP70P | Door lifter

The EP70P door lifter is ideal for taking out heavy or light doors in an easy way. It allows to lift heavy doors like armored doors or fire doors. Its design allows to turn the tool to both sides, making easier the extraction of the door. Furthermore the frontal part is adjustable helping a lot the task of placing the door. The adjustable frontal platform allows a precise work and is covered by a special material against possible scratches. Easily transportable due to its light weight (1 Kg).



Easy and fast extraction of doors, also in difficult cases.

RC29M Corner chisel

This accessory allows to cut the radiuses left by the bit on the corners of the trimmed recesses for hinges, giving an exact 90° corner. It is very useful when fitting hinges with square corners. Solid and ergonomic design protecting the user from the cutting blades.



90° corners with a perfect finishing and in a fast way.

2931093 Set of 2 blades for RC29M

Specifications

Blades dimensions	20x20 mm
Max. cutting radius	20 mm
Max. cutting depth	6 mm



Specifications

Weight	1 kg
--------	------



SP270R | Clamping support

Practical support allowing to hold firmly any piece (panels, doors...) for working safely. High stability. It is possible to hold panels or doors from 6 to 80 mm thickness. It can hold pieces up to 80 kg weight.

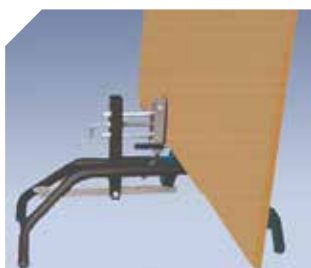

Ideal for fixing doors, panels, etc...



Facilitates the work on doors, allowing a fast and safety fixation.

Specifications

Max. piece thickness	6-80 mm
Max. piece weight	80 kg
Weight	3 kg

7046632

Hinges key

Ideal to unbend hinges on metal doors.



For hinges Ø 18 and 16 mm.



SPR770T | Clamping support with wheels

Practical support with wheels allowing just one person to hold and carry all kind of panels, heavy doors, carpentry parts in wood, aluminum, PVC, etc.

Clamp opening from 6 to 110 mm, both are protected to avoid to damage the holded piece.

Easy and fast use, the piece to be holded is fixed just only with its pressure. Easy extraction thanks to the foot pedal.

The two inflatable pneumatic wheels allow to move the SPR770T in a easy way, even to go up some stairs. The wheels can be blocked for a stationnary use of the support, so it is possible to do some work on the door or panel.

Practical and strong design, ideal for several kind of works for the professional woodworkers.

It is possible to hold and carry pieces up to 200 kg weight.



Allows just only one person to hold and carry all kind of panels, heavy doors.



Carrying a large panel on an irregular floor.



Wheels can be blocked for a stationnary use, so it is possible to work on the edge of the panel or the door.

Specifications

Max. piece thickness	6-110 mm
Max. piece weight	200 kg
Weight	8 kg



Ideal for making lock mortises.

Mount any lock with the FC116U

FC116U | Lock mortiser

Specially designed for quick, precise mortising on doors or other elements, either at the work site or in the workshop. Its special fixing system allows the mortising of doors that have already been hung, without damaging the surface. Its quick measurement adjustment permits multiple mortises to be made in record time. Possibility to trim the frontal lock plate just changing the bit. Equipped as standard with the accessory UT16I which allows to take references for drilling the hole for the handle and key cylinder. Also able to work horizontally. For mortising grooved doors or those with overlap, there is an adjustment system to centre the machine. Optional bits are low cost and easily interchangeable, as they use the same tool-holding shaft.



The machine is also able to work horizontally. Especially useful if deciding to make a series of mortises, with the doors unhung.



Wooden box for carriage.

It also permits to mortise grooved doors or those with overlap, thanks to the possibility of adjusting the centre of the machine over the section of the door where the mortise is required.



Standard equipment

Equipped from factory with carbide lock mortiser bit Ø 16 mm, locking bar to make mortises on several doors at the same height, rubber protectors for delicate jobs, service keys, dust collector connection and UT16I drilling accessory.

Video



The FC116U incorporates a locking bar, which is fixed to the machine at the height from the ground established for the first mortised door, allowing the mortising of the rest of the doors at the same height without retaking measurements.

Specifications

Input power	1,100 W
Max. bit Ø	30 mm
No-load speed	23,000/min
Max. mortising depth	0-125 mm
Max. mortising length	177 mm+bit Ø
Max. clamp vise opening	190 mm



Optional bits

Sharing the same tool-holding shaft.
Easily interchangeable.

1640138 Set of 5 carbide bits
Diameters: 18, 21, 23, 25, 30 mm (ref. 1640138)

(*) Bit included with standard equipment.

- 1640127 Carbide bit Ø 16 mm*
- 1640150 Carbide bit Ø 17 mm
- 1640128 Carbide bit Ø 18 mm
- 1640367 Carbide bit Ø 20 mm
- 1640129 Carbide bit Ø 21 mm
- 1640378 Carbide bit Ø 22 mm
- 1640130 Carbide bit Ø 23 mm
- 1640368 Carbide bit Ø 23.5 mm
- 1640131 Carbide bit Ø 25 mm
- 1640369 Carbide bit Ø 29 mm
- 1640132 Carbide bit Ø 30 mm
- 1640140 Drilling bit

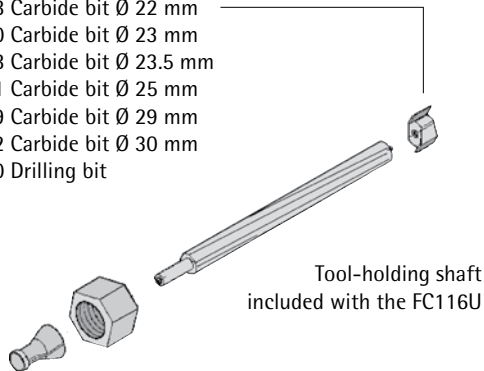

The clamp extension UP16I allows to fix the machine also on both ends of the door.



The accessory UT16I allows to take references for drilling the hole for the handle and key cylinder.



Optional accessories

- 1645287 UP16I Clamp extension
- 1645288 UT16I Drilling accessory
- 1640148 Carb. drilling bit* 2 c. Ø 18 mm **A**
- 1640149 Carb. drilling bit* 2 c. Ø 23 mm **B**

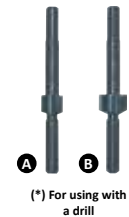

UC16K | Lock mortising template holder

UC16K is designed for making frontal and lateral recesses for any kind of lock on doors and frames. Designed for use with the router FR66P or FR160P, it is especially recommended for making recesses for locks that open with magnetic anti-panic cards and special opening devices. Its exclusive attachment system by means of clamp vises enables the user to mortise doors that have already been hung without damaging the surface. Secure, reliable grip. Works horizontally also. UC16K includes a height bar, making possible identical recesses on several doors at the same height, with no need to readjust the lock mortising template holder.



Specifications

Work area on door front: 80 x 300 mm.
Work area on door edge: 55 x 300 mm.
Maximum opening of clamp vises: 190 mm.
Maximum grip of clamp vises: 13 mm.
Maximum trimming depth: 60 mm.

Standard equipment

Set of templates, template guide for (FR66P /FR160P) and service keys.

Optional bits

1640157 Carbide bit Ø 12 mm (for FR66P)
1640258 Carbide bit Ø 12 mm (for FR160P)
(see page 48)



Additional sets may be ordered separately (ref. 1645365)



Making side holes for placing the knob, cylinder or other mechanisms.



Using UC16K together with FR66P enables the user to quickly make recesses of exceptionally high quality.



UC16K gives extraordinary results on frames too.



Using UC16K with the FR66P enables the user to make recesses for the box-staple or lock and the holes for the latch and lever



The UC16K is necessary when placing magnetic card locks, anti-panic locks and other special kind of locks.



PB83E | Template for placing door frames

The template is designed to facilitate the fast and perfect placement of frames and butt straps in doorsteads, securing them by means of polyurethane foam. The frames and butt straps can be placed in new or old doorsteads, and the existing door can be used in the latter case. The use of polyurethane foam guarantees total durability, making the door extremely robust. It sets fast (in under 10 minutes), enabling rapid work and optimum use of the available time.



Long lasting fixation thanks to the polyurethane foam.



Double door kit ref. 8345175.

Optional accessories

8345175 Extension for placing frames and butt straps in doorsteads for double or special sized doors.

Width from 1,240 to 1,640 mm

Many different door sizes

The template supports a wide range of door sizes, based on standard UNE 56802.

Door sizes supported:

Height from 1,905 to 2,160 mm

Width from 620 to 1,020 mm

Depth from 35 to 45 mm

Fast setting



Adjustment of measurements on the PB83E in function of the door to be placed.

For cutting the old frame we recommend our cutting machine model RM95R.

Anyway the cut can be also made by mean of any other kind of saw or manual tool.

In the case of new constructions, this process is not necessary.



Securing the frames to the template.

Easy placement



Placement of the PB83E, flush with the doorstead.



Filling with polyurethane foam.



Placing the butt straps using the stops provided.

It is not necessary to change the settings of the PB83E when removing it from the finished door. This means that we can fit as many doors as required with the same measurements.

Profile of finished door

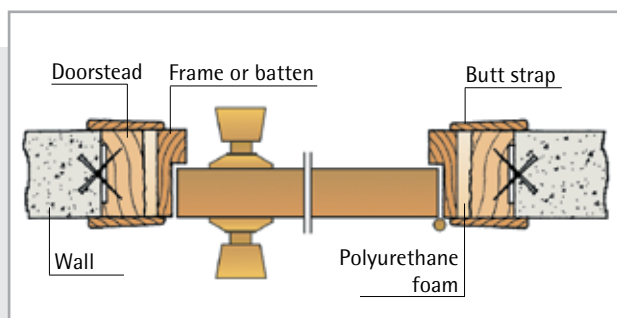



www.virutex.es



Woodworking machinery and tools



2016 / 2017



Professional solutions

NEY Ltd (Head Office)
Stonebridge Trading Estate
Sibree Road
Coventry
CV3 4FD

T: 024 7630 8100
F: 024 7630 8101
machines.info@ney.co.uk

NEY Ireland
Unit 22 Blaris Industrial Estate
Altona Road
Lisburn
BT27 5QB

T: 028 92 673 000
F: 028 92 672 999
ireland@ney.co.uk

NEY Scotland
Block 2 Units 1-2-3,
Bandeath Ind Est, Throsk
Stirling,
FK7 7NP

T: 01786 814 814
F: 01786 814 812
scotland@ney.co.uk

www.ney.co.uk

A comprehensive approach to the Woodworking Industry